

# Controller dimensions

5300

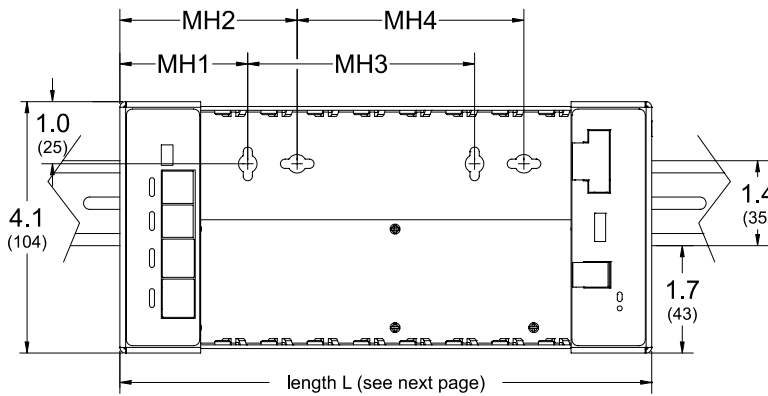

## Mounting hole positions<sup>2</sup>

Rack	MH1	MH2	MH3	MH4
0 slots	0.8 (20)	n/a <sup>3</sup>	0.9 (23)	n/a <sup>3</sup>
2 slots	1.3 (33)	n/a <sup>3</sup>	1.6 (41)	n/a <sup>3</sup>
4 slots	1.5 (38)	2.3 (58)	1.9 (48)	1.9 (48)
8 slots	2.1 (53)	2.9 (74)	3.7 (94)	3.7 (94)

## Keyhole dimensions (horizontal mounting)<sup>4</sup>

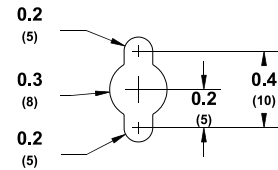

## Mounting options

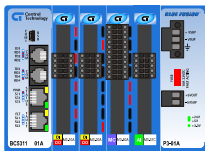

Horizontal

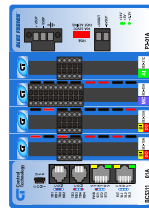

Vertical

### Notes

1. All dimensions on this page are in inches (mm).
2. Mounting hole positions table lists specifications for a single-bay CPU module. For a 2-bay CPU module, add 1.3 in (66 mm) to the dimensions MH1 and MH2.
3. 0- and 2-slot controllers are horizontal mounting only.
4. Dimensions for vertical mounting keyhole are the same as horizontal, rotated 90°.

# 5300 Automation Controller

## Calculating controller length

To determine the controller length L, add the length of all modules in the controller. Individual module lengths are given in the table below.

Part Number	Description	Length	
		inches	mm
<b>CPU modules</b>			
EQ5310	Ethernet Quicklink controller	1.30	33
BC5311	200 MHz G3 CPU	1.30	33
BC5321	200 MHz G3 CPU, 1 processor board	2.60	66
BC5322	Dual 200 MHz G3 CPU	2.60	66
<b>I/O modules</b>			
All modules	I/O modules	0.75	19
<b>Rack bridge</b>			
R3-90A	Rack bridge	2.60	66
<b>Power modules</b>			
P3-01A		1.30	33
P3-02A		2.60	66
P3-01B		1.30	33
P3-02B		2.60	66

### Example

The following diagram depicts a 16-module controller with a 1-bay CPU and a Rack bridge.

